

Important: Always disconnect the power before installing or replacing bulbs and before cleaning or other maintenance.

This light should be installed by a licensed electrician

LAMP INSTALLATION AND ASSEMBLY

1. Shut off power to the outlet box. (fig. A)
2. Attach the mounting plate to the outlet box, secure with outlet box screws.
Use anchors and wood screws for extra support (included)
3. Make appropriate electrical connections using wire nuts:
 - a. Connect the fixture's live wire (black) to the live outlet box wire.
 - b. Connect the fixture's neutral wire (white) to the neutral outlet box wire.
 - c. Connect fixture's ground wire (green or uncoated) to the ground outlet box wire. If no ground is present in outlet box, connect fixture's ground wire to the mounting plate using the green screw (included).
 - d. Carefully place connections in outlet box.
4. Attach the back plate to the mounting plate, secure with mounting screws.
5. Install 60w medium base T-type bulb. (not included)
6. Screw the mesh shade to threaded socket.
7. Restore power to the fixture.

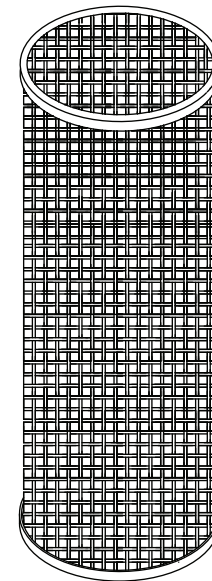
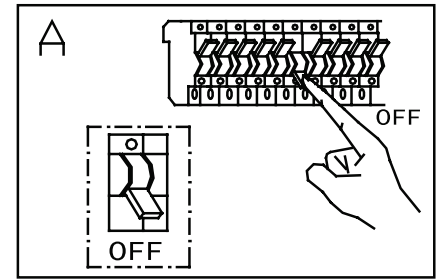

— mesh shade

CARE INSTRUCTIONS

Dusting — Use a clean, dry cloth.

Cleaning — To protect the finish, avoid any harsh abrasives or chemicals.

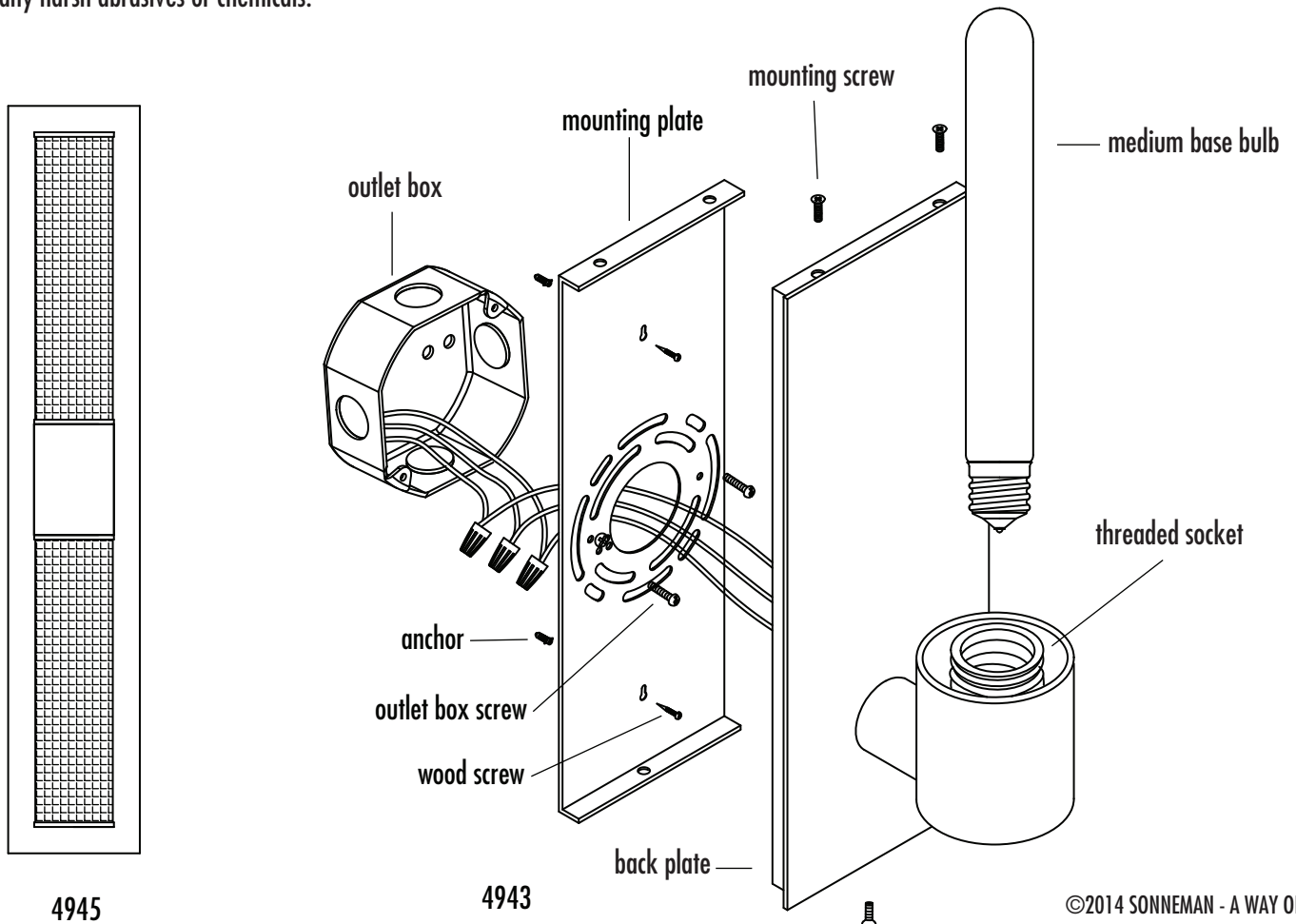

4945

4943