

Pi

3997, 3998

12" Round
Recessed LED Panel

20" Round
Recessed LED Panel

Product Information and Warnings

IMPORTANT

- **Always disconnect the power before installing or replacing Luminaires and before cleaning or other maintenance.**
- **Consult a qualified, licensed electrician to ensure correct branch circuit conductor.**
- ***Consulter un électricien qualifié pour vous assurer que les conducteurs de la dérivation sont adéquats.***
- Please read all included assembly instructions and warnings carefully before installation. Contact Customer Service if you have any questions or concerns. Before installation, please confirm that the fixture is compatible with your supply voltage and dimming system, if present.
- LEDs are highly sensitive electronic devices, and must be treated with care. Do not open any factory sealed compartments, and avoid touching the LEDs with your hands or any object.
- Although all our fixtures are equipped with protective devices, LED electronic systems are vulnerable to power surges and supply variations. Do not install LED fixtures on the same circuit as any motors, appliances, or HVAC systems.
- Do not remove or bypass any LED Driver or Transformer that is provided with the fixture, and do not replace or substitute with another power supply.
- Fixtures must be wired in parallel on independent leads; do not "daisy chain" multiple fixtures together or wire them in series.
- All factory-made splices and connections must remain intact. LED circuits are carefully designed and built, and improper connections may damage the fixture.
- The ends of coaxial pendant cords have been precisely stripped and split at the factory and must not be field cut. Excess cord or cable should be neatly coiled and reserved in the fixture canopy.
- Any mounting hardware is provided for your convenience and should be used with discretion. Always use the appropriate hardware for the mounting surface.

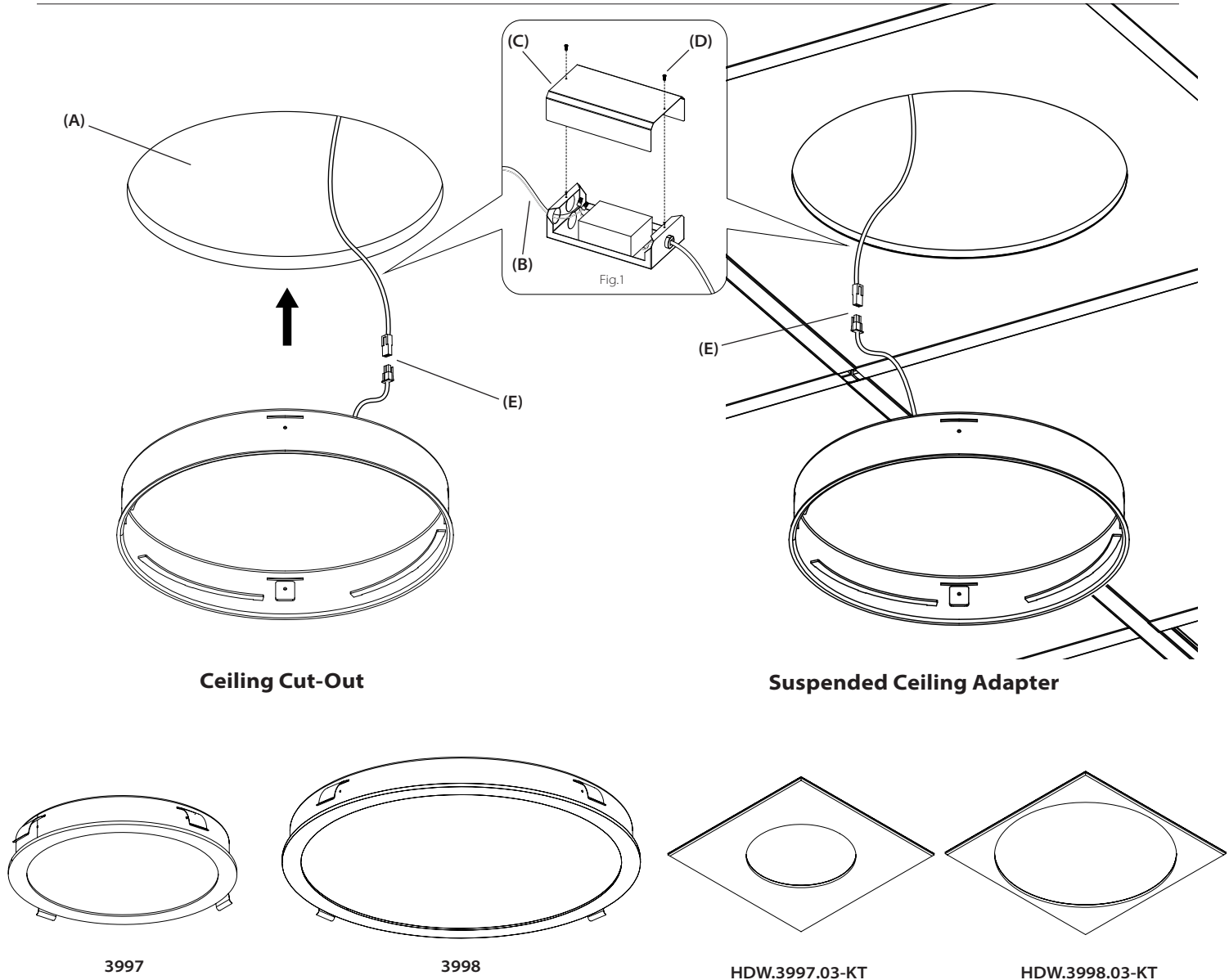

1. Shut off power at the electrical panel.

2. **Ceiling Cut-Out:**

Cut hole (A) in the mounting surface for the recessed LED panel to install.

For 3997, the diameter of the cutout is 350mm (13¾ in)

For 3998, the diameter of the cutout is 550mm (21⅞ in)

Suspended Ceiling Adapter:

Install Suspended Ceiling Adapter (HDW.3997.03-KT or HDW.3998.03-KT) into 2ft x 2ft drop ceiling, in accordance with Drop Ceiling Frame standards, with either the field paintable or acoustic panel side down.

3. Run Branch Circuit Conductors (B) from the electrical panel into the remote enclosure included with fixture (Fig.1).

4. Make appropriate electrical connections using wire nuts:

- Connect the Power Supply's live wire to the live supply wire.
- Connect the Power Supply's neutral wire to the neutral supply wire.
- Connect the Remote Enclosure's ground wire (green or uncoated) to the ground supply wire.

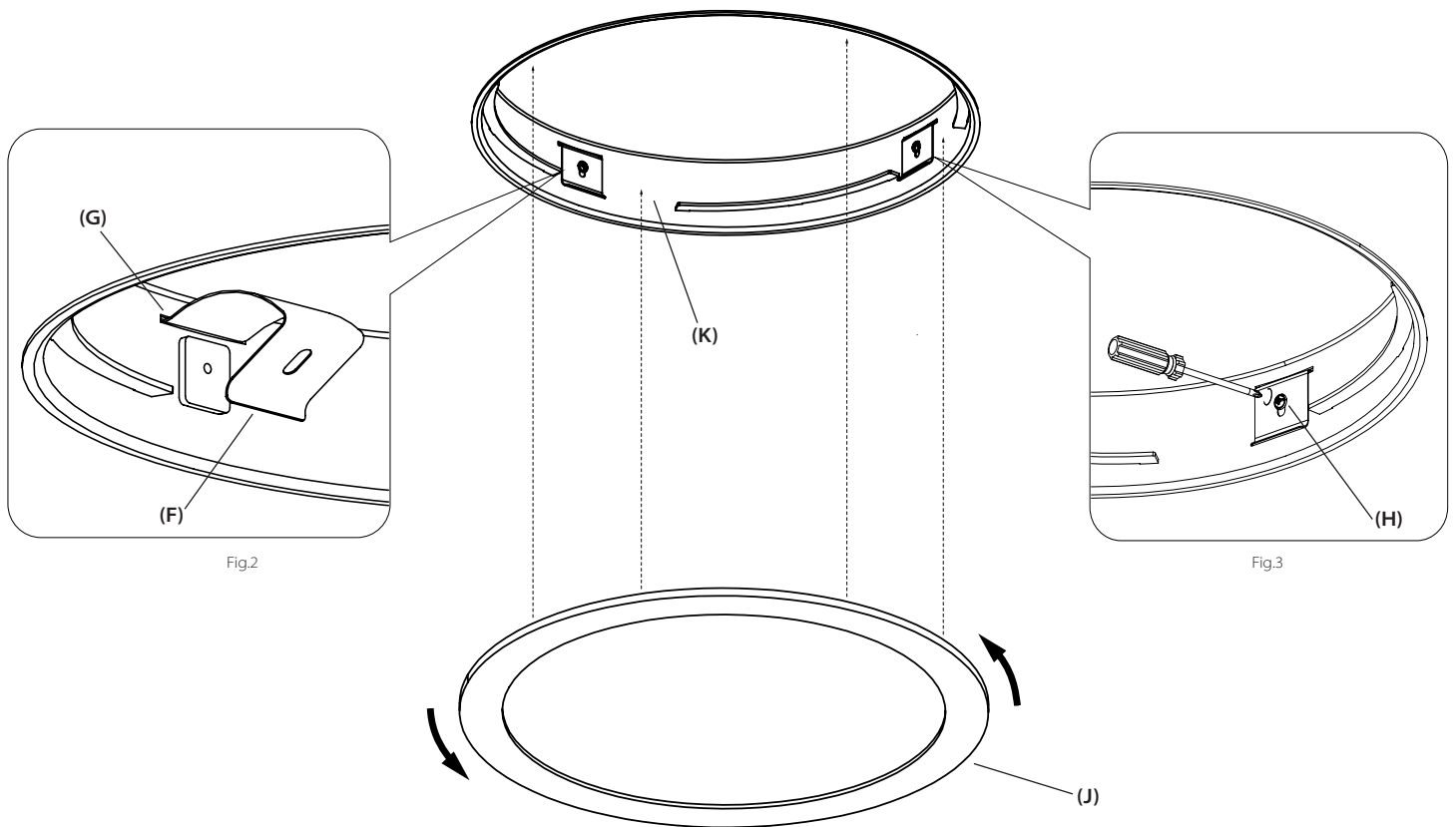

5. Carefully place connections inside the remote enclosure, fasten the box cover (C) with provided screws (D) and insert into ceiling with plug lead hanging through the hole.
6. Connect the plug from the remote enclosure to the plug of the fixture (E) and push the fixture up into the cutout hole using the included foam pad to protect the LEDs.

Spring Wing Guide	
Ceiling Thickness	Spring Wing Type
1" and Under	A
Over 1"	B

7. Once the fixture is in location, insert a spring wing (F) into a slot (G) of the fixture (Fig.2) and tighten with screw (H) and screwdriver. (Fig.3). Refer to above Spring Wing Guide for spring wing selection.
8. Repeat Step 7 for 3 remaining spring wings.
9. After the fixture is mounted, assemble diffuser (J), making sure to line up the four diffuser posts into the matching slots (K).
10. Turn the diffuser counterclockwise to fasten into the fixture.
11. Restore power to the fixture.

Note:
This fixture is dimmable with ELV (Trailing-Edge), Incandescent (Leading-Edge), and 0-10V type dimmers only.

Care Instructions:
Use a clean, dry cloth when dusting.
To protect the finish, avoid any harsh abrasives or chemicals.